

Rion Roof Vent Opener Installation Instructions

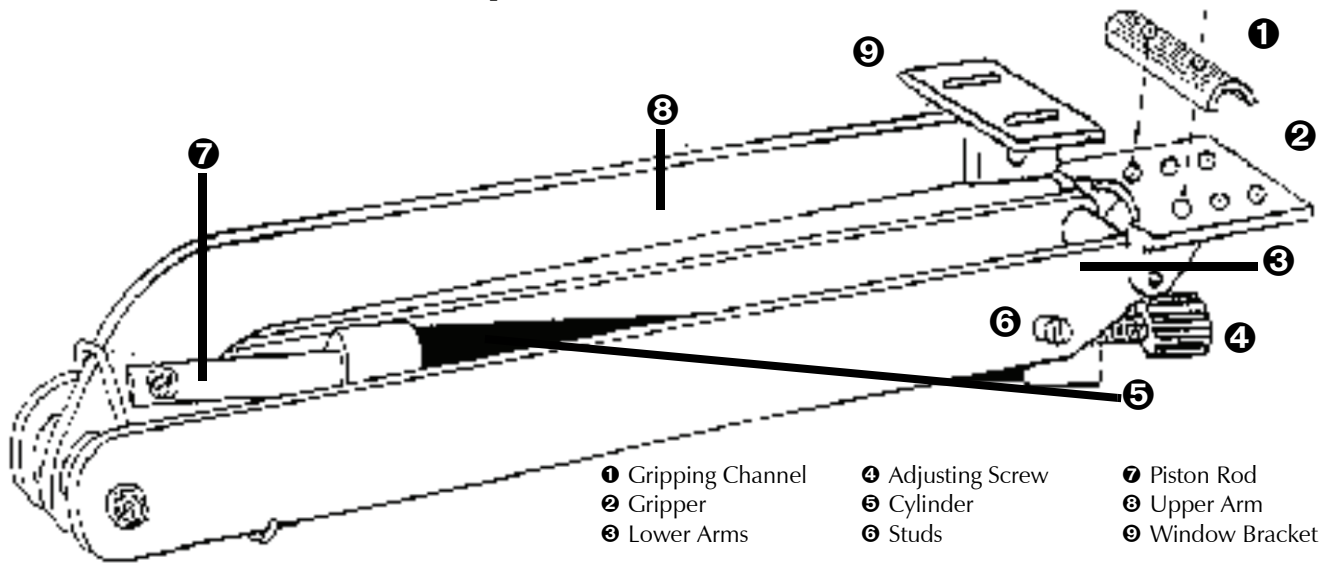

Installation

Note: Do not remove the window handles until you have fitted your autovent opener.

- 1 Fit the gripping channel (1) into the groove in the sill bar, inserting one edge at a time, ensuring it locks firmly into place. Slide gripping channel (1) along the sill bar and position in line with the central mounting pad on the bottom rail of the window.
- 2 To assemble the cylinder to the bracket feed the piston rod (7) into the end of the cylinder (5), push it firmly into place, and secure to lower arms (6) using threaded studs (6) provided. It may be necessary to slightly open the arms to do this.
- 3 After assembling unit turn the adjusting screw (4) clockwise until the arms are approximately 15 cm (6") apart.
- 4 Close and lock window. Using the two holes in the central mounting pad loosely fit the window bracket (9) by means of the 2 x 3/8" self tapping screws provided, ensuring the top arm (8) does not touch the polycarbonate glazing in the window.
- 5 Line the top edge of the window bracket (9) with the top edge of the central mounting pad and tighten screws.
- 6 Ensure the lower arms (6) are in line with the upper arm (8), and the gripping channel (1) is in line with the gripper (2). (If necessary drill through the holes in the gripping channel (1) and sill bar using a 3 mm drill.) Using the top holes in the gripper (2) attach it to the gripping channel (1) and sill bar by means of the 2 x 1" self tapping screws provided.
- 7 Remove window handles and retain with pivot pins.

Note: It is recommended that the cylinder be removed for the winter and the handles refitted.

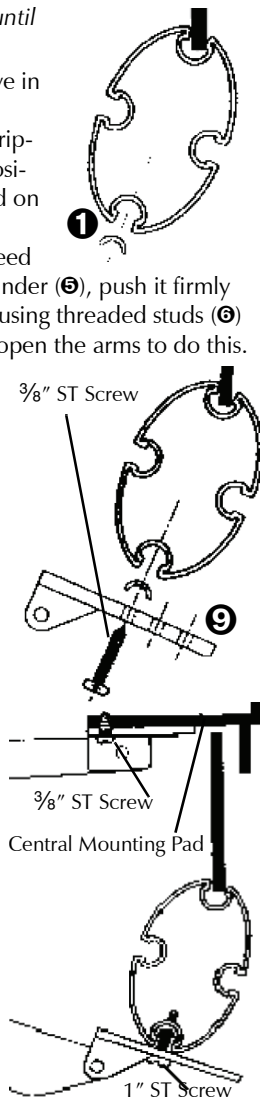

Adjustment

After allowing the autovent cylinder to reach the temperature at which you require the window to start opening hold the window slightly open and firmly turn the adjusting screw in the direction of the 'LO' arrow (clockwise) until the unit begins to support the window without assistance. Any rise in greenhouse temperature will now cause the window to open wider. If further adjustment is required repeat the process ensuring the weight of the window is taken off the unit as before.

By turning the adjusting screw in the direction of the 'LO' arrow (clockwise) the window starts opening at a lower temperature. If the adjusting screw is turned in the direction of the 'HI' arrow (anti-clockwise) the window will not open until a higher temperature is reached.

Note: Adjustment is made easier if the window is pushed slightly open. As the cylinder is so positioned to also allow it to sense the effects of any chilling air from outside it will automatically react to this and adjust the window accordingly, giving added protection to your plants.

Note: Do not heat to more than 50°C (122°F)

Do not apply excessive loads by locking or covering window
Do not attempt to dismantle the cylinder

Technical Information

Opening temperature range adjustable between 15°C and 25°C (59°F and 77°F)

Maintenance

Lubricate all moving parts after fitting and each subsequent spring and autumn using a light oil. Use grease or petroleum jelly for the piston rod.

After long periods of low temperatures and at least once a year take the weight of the window with one hand and move the adjusting screw slowly clockwise three or four turns then move it anti-clockwise to its original position.

Guarantee

Provided the autovent has been correctly fitted in accordance with these instructions it carries a one year guarantee from date of purchase. Should it fail to operate during this period please return either the complete unit or defective part to the address shown on these instructions.

Patents:: U.K. 1562431 1592126 0017357 U.S.A. 4140017 4450687